

Quick-Slip Heater Installation

THE **SLIP HEATER** is a heating system that has been designed to be installed by slipping it under the seat back cover in a minimal amount of time with readily available tools. The unique design allows the driver and passenger to experience soothing warmth in the Lumbar area in almost all of today's vehicles.

GENERAL ADVICE:

- The SlipHeater is to be installed by slipping the heater under the seat back cover. Always check the heater placement on the seat prior to beginning any work. Make sure there are no vertical tie-down seams or any obstacles that would not allow the element to be installed.
- Check for Occupant Detection System in the seat back prior to installing. The lumbar heater cannot be installed over an Occupant Detection System.
- The installer is liable for any damage due to improper installation.
- All steps explained in this manual are to be followed with great care. Installation has to be performed by qualified personnel only. Improper installation will void the limited warranty provided by the manufacturer and may cause physical damage to equipment or people.
- The heating system has to be connected to 12 volt accessory power. It is necessary that the system is capable of driving up to 5 Amps continuous current.
- The heating element has to be installed without any folds.
- The heating element is not to be modified by folding, cutting or in any other way.
- The wire harness has to be fitted to the seat in a way that the full range of movement of the seat is possible without damaging the wire harness.
- Cars fitted with side airbags have to be treated according to the manufacturers fitting manuals. The heating element is only to be attached to the middle of the seat back foam. The connections of the side airbag(s) have to be handled thoroughly and should never be connected to any kind of power supply during the fitting process.

Heater Installation:

1. Recline the seat back so the seat cover attachments are visible. These are normally a plastic clip or metal rings. Remove the rings or using a flat screw driver, pry the plastic clips and separate.
2. Carefully, insert your hand confirm that the heater can be placed on the seat foam and in the lumbar area.
3. Slip the heater under the seat cover and place in desired location. Recheck the location and remove the adhesive backing at the top of the heater. Press the heater to the foam; recheck the placement and then slowly pull the adhesive backing while applying pressure to the heater. Recheck the heater for any folds or overlaps.
4. Run the wiring to the seat bottom and then re-attach the back cover.
5. Locate the switch location and create a $\frac{3}{4}$ " hole and install the switch and connect to the harness
6. Connect the harness to vehicle accessory power and check for operation.

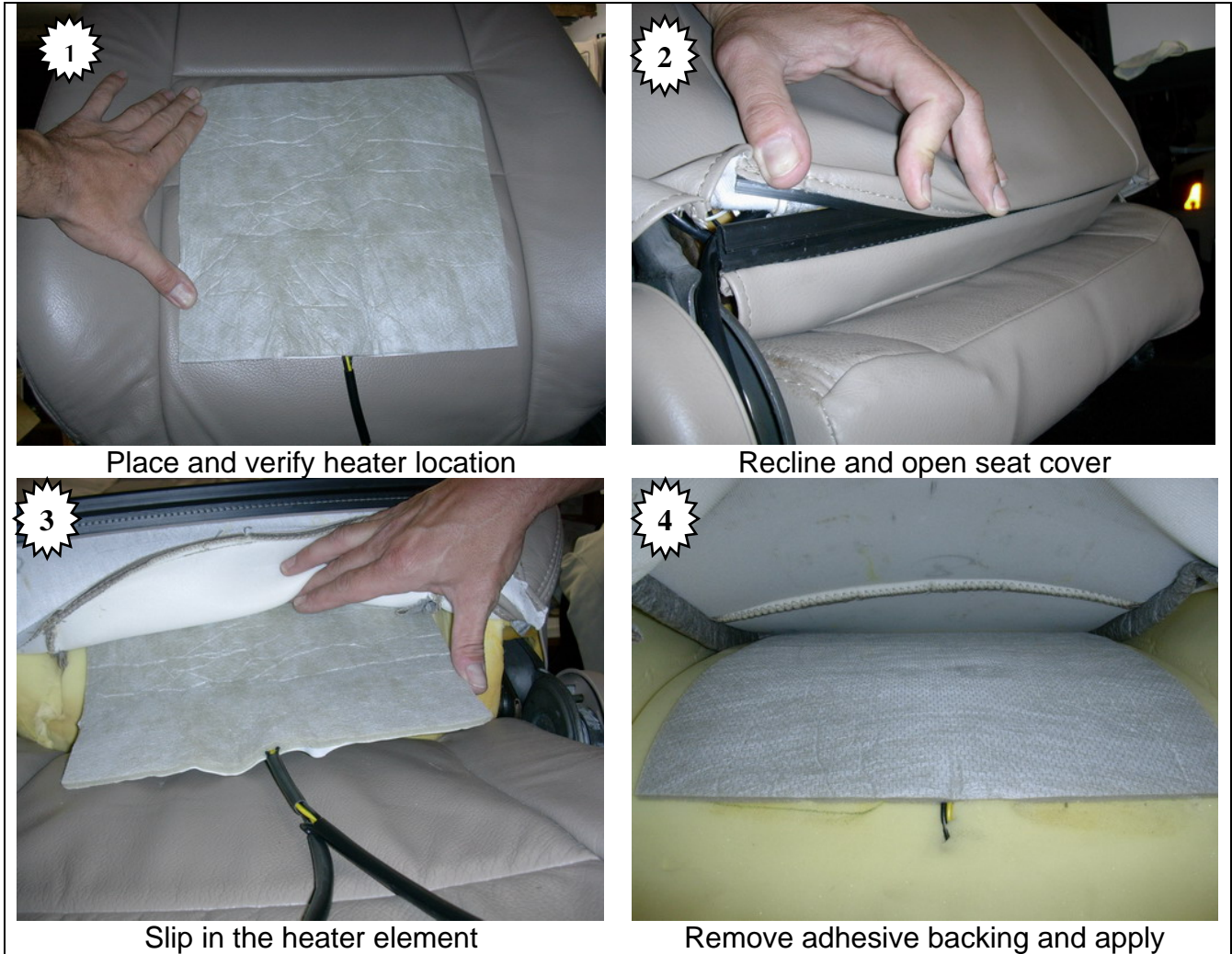

Switch Connection

Connect the switch harness wires to the on/off switch:

Yellow wire- end connector (silver): directly below seat heater symbol

Red wire- middle connector (silver)

Black wire- end connector (brass): directly below switch led.

